

# AMERDRAIN® 200/220

## PREFABRICATED SHEET DRAIN



### PRODUCT OVERVIEW

AMERDRAIN 200/220 sheet drain is designed for vertical wall, single sided drainage applications. The moderate compression strength and flow rate is ideal for light commercial and residential applications. AMERDRAIN 200/220 also functions as a protection course to waterproofing membranes and can be used horizontally under floor slabs.

The three-dimensional molded core is covered with a nonwoven polypropylene filter fabric. The fabric is bonded to each dimple and retains soil particles while allowing maximum water collection into the drainage core. The core provides an uninterrupted path for water to flow to designated drainage exits.

AMERDRAIN 220 has a polymeric film bonded to the back side of the core to offer additional protection to soft waterproofing membranes.

TECHNICAL DATA			200 / 220
Physical Properties	ASTM Test Method	Unit of Measure	Typical Value
<b>FABRIC</b>			
Material <sup>1</sup>			PP
Water Flow Rate	D-4491	gpm/ft <sup>2</sup>	165
		Lpm/m <sup>2</sup>	6,724
Grab Tensile Strength	D-4632	lbs	100
		N	445
Puncture Resistance	D-4833	lbs	65
		N	289
Apparent Opening Size	D-4751	sieve	70
		mm	0.21
Grab Elongation	D-4632	%	65
UV Resistance	D-4355	% / 500 Hrs	70
<b>CORE</b>			
Material <sup>1</sup>			HIPS
Thickness	D-1777	in	0.25
		mm	6.35
Compressive Strength	D-1621	psf	11,000
		kPa	527
Flow Rate <sup>2</sup>	D-4716	gpm/ft	12.5
		Lpm/m	155
Recycled Content			74% / 71%
<small>1- PP = Polypropylene; HIPS = High Impact Polystyrene            2 - In-plane flow rate measured at 3,600 psf (172 kPa) compressive load and a hydraulic gradient of 1.0.</small>			

## AMERDRAIN®

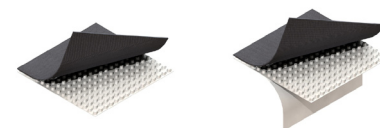

### PACKAGING

- » 4' x 50' Rolls
- » 6 Rolls per pallet

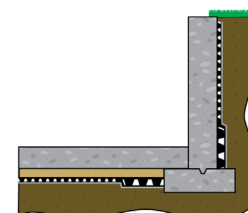

### COLLECTION SYSTEMS

AMERDRAIN Total- Drain can be used with the AMERDRAIN sheet drains to provide a more efficient collection and transportation system to direct collected water to designated drainage exits.



All information, drawings and specifications are based on the latest product information available at the time of printing. Constant improvement and engineering progress make it necessary that we reserve the right to make changes without notice. All physical properties are typical values unless otherwise stated. Standard variations in mechanical properties of 10% and in hydraulic properties of 20% are normal.



1209 Airport Road, Monroe, NC 28110  
 TF 800.242.WICK • PH 704.238.9200  
 FX 704.238.0220 • info@americanwick.com

